

Oil Levels and Windows

OIL LEVELS

WITH LOCKNUT (DIN 3018)

Material - BRASS, GLASS Finish - NATURAL
Maximum Working Temperature 90°C

Product Code	A	B mm	C mm	D mm
FGM 150	1/8	50	13	27
FGM 160	BSP	60	13	27
FGM 180		80	13	27
FGM 250		50	13	27
FGM 260	1/4 BSP	60	13	27
FGM 280		80	13	27
FGM 2100		100	13	27
FGM 2125		125	13	27
FGM 2150		150	13	27
FGM 2175		175	13	27
FGM 2200		200	13	27
FGM 2250		250	13	27
FGM 2300		300	13	27
FGM 350		3/8 BSP	50	13
FGM 360	60		13	34
FGM 380	80		13	34
FGM 3100	100		13	34
FGM 3125	125		13	34
FGM 3150	150		13	34
FGM 3175	175		13	34
FGM 3200	200		13	34
FGM 3250	250		13	34
FGM 3300	300		13	34
FGM 4100	1/2 BSP	100	16	38
FGM 4125		125	16	38
FGM 4150		150	16	38
FGM 4200		200	16	38
FGM 4250		250	16	38

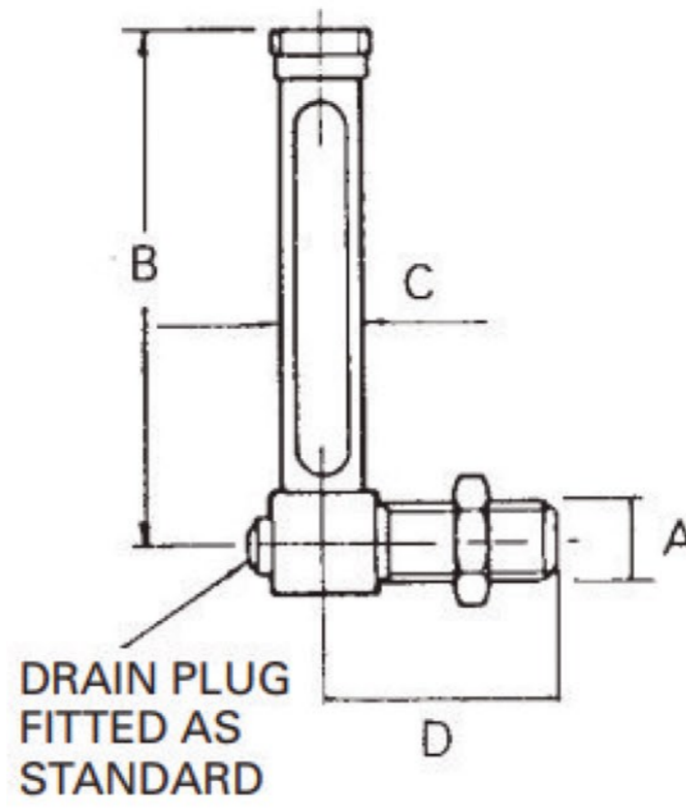

WITH BANJO COUPLING (DIN 3018)

Material - BRASS, GLASS. Finish - NATURAL
Maximum Working Temperature 90°C

Product Code	A	B mm	C mm	D mm
FGB 160	1/8 BSP	60	16	28
FGB 180		80	16	28
FGB 1100		100	16	28
FGB 1125		125	16	28
FGB 250	1/4 BSP	50	16	30
FGB 260		60	16	30
FGB 280		80	16	30
FGB 2100		100	16	30
FGB 2125		125	16	30
FGB 2150		150	16	30
FGB 2175		175	16	30
FGB 2200		200	16	30
FGB 2250		250	16	30
FGB 2300		300	16	30

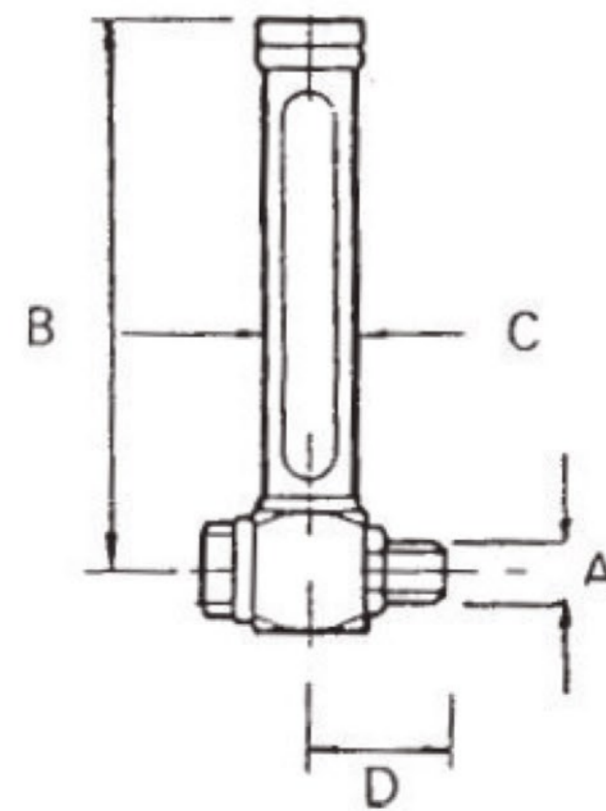

3/8 BSP, 1/2 BSP and NPT sizes available on request

Oil Levels and Windows

OIL LEVELS

VERTICAL (DIN 3018)

Material - BRASS, GLASS. Finish - NATURAL

Maximum Working Temperature 90°C

Product Code	A	B mm	C mm	D mm
FGV 250		50	13	8
FGV 260		60	13	8
FGV 280		80	13	8
FGV 2100		100	13	8
FGV 2125	1/4	125	13	8
FGV 2150	BSP	150	13	8
FGV 2175		175	13	8
FGV 2200		200	13	8
FGV 2250		250	13	8
FGV 2300		300	13	8

3/8 BSP, 1/2 BSP and NPT sizes available on request

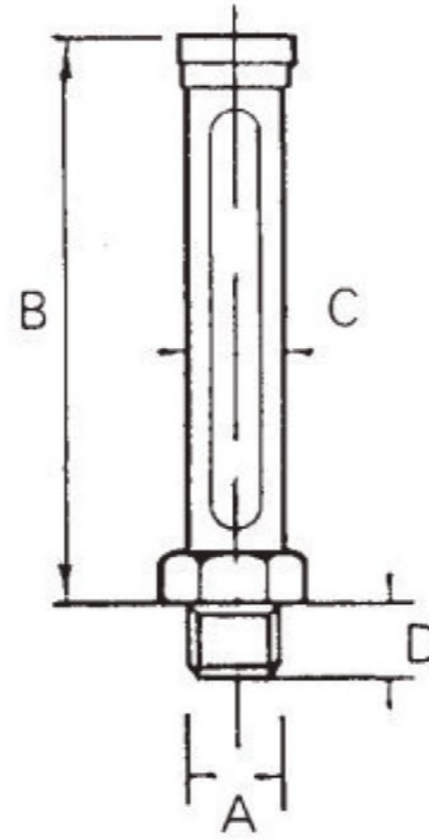

OIL LINE FLOW

Material - BRASS, GLASS, NITRILE. Finish - NATURAL.

Maximum Working Pressure 2 bar.

Maximum Working Temperature 80°C

Product Code	A	B	C mm	A/FLATS mm
OL 4279	1/8 BSP	1/8 BSP	70	19
OL 4280	1/8 NPT	1/8 NPT	70	19
OL 4281	1/4 BSP	1/4 BSP	62	21
OL 4282	1/4 NPT	1/4 NPT	62	21
OL 4283	3/8 BSP	3/8 BSP	76	31.75
OL 4284	3/8 NPT	3/8 NPT	76	31.75
OL 4285	1/2 BSP	1/2 BSP	70	32
OL 4286	1/2 NPT	1/2 NPT	70	32

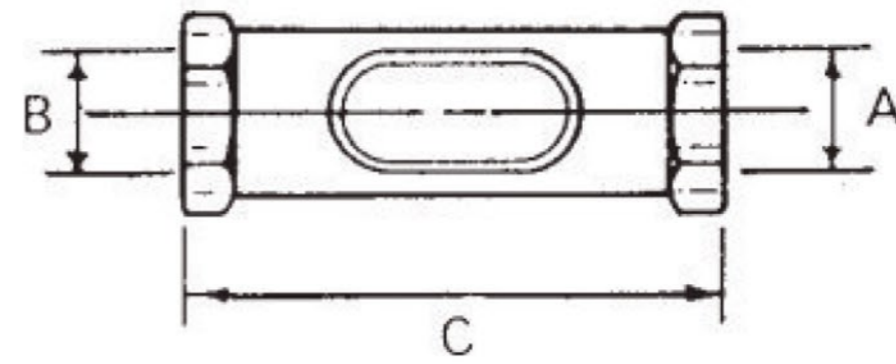

FLANGED

Material - BRASS, GLASS. Finish - NATURAL

Maximum Working Pressure 1 bar.

Maximum Working Temperature 100°C

Product Code	A mm	B mm	C mm	D mm	E mm	F mm	G mm
CW 4032	31.8	57.2	46.8	4.8	9.5	17.5	31.8
CW 4033	38.1	65.1	54.8	4.8	9.5	17.5	38.1



DRIVE IN

Material - STEEL, PERSPEX. Finish - ZINC PLATE

Maximum Working Pressure 0.7 bar.

Maximum Working Temperature 70°C with 0.2 bar pressure

Product Code	Hole Diameter	A	B mm	C mm	D mm
DW 4064	22.23 - 22.28	22.30 - 22.35	17.5	7.1	0.4
DW 4061	31.75 - 31.80	31.83 - 31.88	25.4	8.7	0.4
DW 4062	38.10 - 38.15	38.18 - 38.23	31.8	9.5	0.4
DW 4063	50.80 - 50.85	50.88 - 50.93	44.5	10.8	0.4

Add suffix 'A' to part No. if reflector is required.

